

Holme
Eden
05

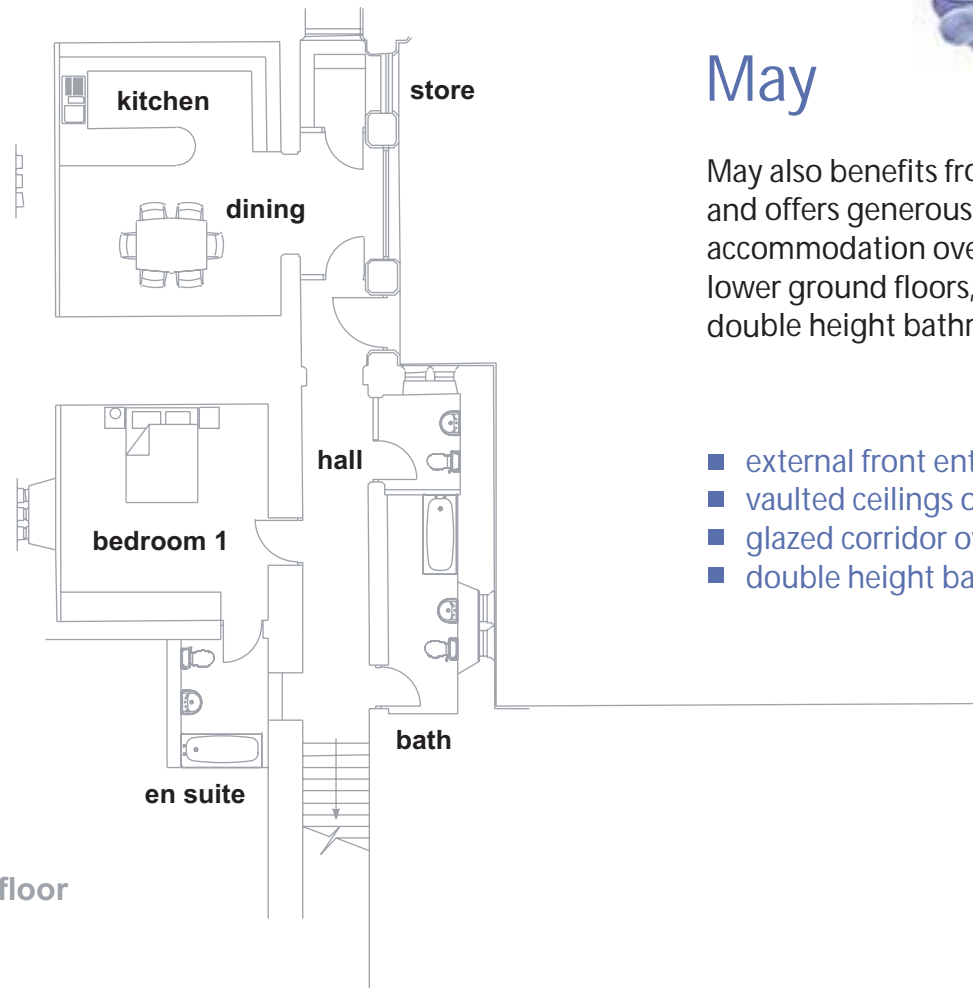

lower ground floor



May

May also benefits from its own entrance, and offers generous two-bedroom accommodation over the ground and lower ground floors, including a glorious double height bathroom and glazed cloisters.

- external front entrance
- vaulted ceilings overlooking courtyard
- glazed corridor overlooking courtyard
- double height bathroom